

NOTES
 1. REFER TO SPECIFICATIONS FOR MODEL UNITS, COORDINATE LOCATION OF MODEL UNITS WITH ARCHITECT & OWNER DURING CONSTRUCTION.

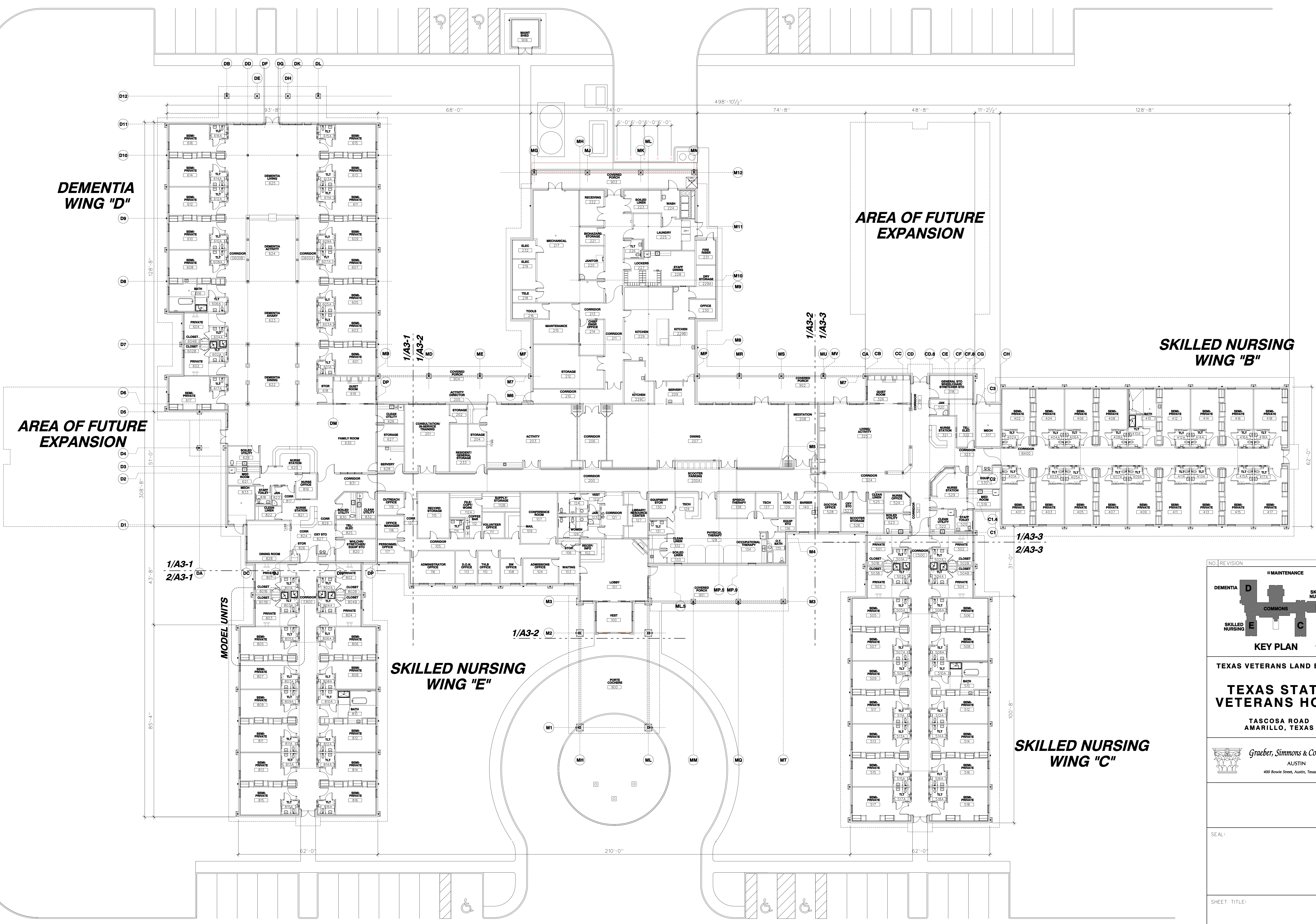

DEMENTIA WING "D"

AREA OF FUTURE EXPANSION

SKILLED NURSING WING "B"

AREA OF FUTURE EXPANSION

SKILLED NURSING WING "E"

SKILLED NURSING WING "C"

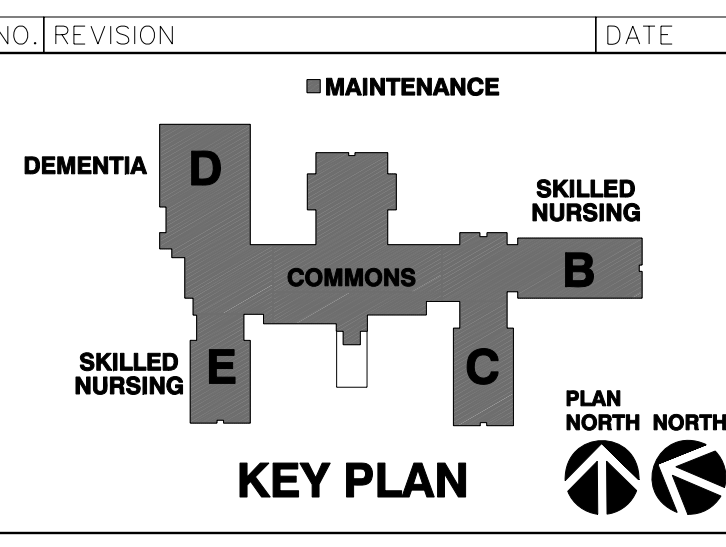

TEXAS VETERANS LAND BOARD
TEXAS STATE VETERANS HOME
 TASCOSA ROAD
 AMARILLO, TEXAS

Graber, Simmons & Cowan, Inc.
 AUSTIN
 400 Bowie Street, Austin, Texas 78703

SEAL:
 SHEET TITLE:
OVERALL FLOOR PLAN

DATE: 1/5/2005 PRJ. NO.: 200402300
 DRAWN BY: EPR SHEET NO.:
 CHECKED BY: EPR
 SCALE: 1/16" = 1'-0" **A3-0**

02/08/2007
 02:52:59 PM
 m:\prj\200402300\vrch\SH\T\lva0300.dgn

VETERANS' HOME - VETERANS' LAND BOARD OF THE STATE OF TEXAS
 CONSTRUCTION DOCUMENTS
 1/5/2005